

- Home
- Fasteners
- Bars
- Rods
- Wire
- Forgings
- Rings
- Pins
- Keys

Home / Fasteners / Heavy Hex Nuts

ASTM A453 Grade 660 Heavy Hex Nuts

Class A/B/C/D

ASTM A453 Grade 660 Heavy Hex Nuts Class A, B, C & D offered at TorqBolt are manufactured in accordance with ASME B18.2.6M, B18.2.4.6M, ASME B18.2.2, ISO 4033 standards in metric and imperial coarse and fine thread sizes with UNC, UN, UNF, UNEF, UNJF & ISO threads.

ASTM A453 Grade 660 Heavy Hex Nuts Class

- CLASS A HEAVY HEX NUTS
- CLASS B HEAVY HEX NUTS
- CLASS C HEAVY HEX NUTS
- CLASS D HEAVY HEX NUTS

Dimensions of Heavy Hex Nuts and Heavy Hex Jam Nuts in mm ASME B 18.2.2

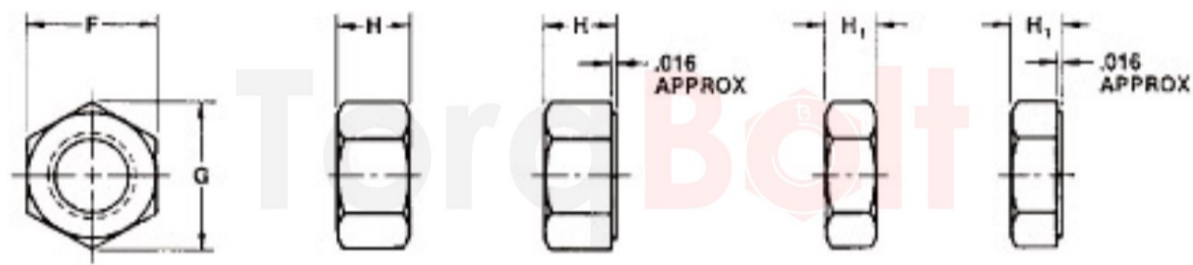

Nominal Sizes	Width Across Flats		Width Across Corners		Thickness		Thickness	
	F		G		H		H1	
	min	max	min	max	min	max	min	max
1/4	12,40	12,70	14,12	14,65	5,54	6,35	3,96	4,78
5/16	13,86	14,29	15,80	16,51	7,11	7,97	4,72	5,59
3/8	16,99	17,46	19,38	20,17	8,66	9,58	5,49	6,40
7/16	18,49	19,05	21,08	22,00	10,24	11,20	6,27	7,24
1/2	21,59	22,22	24,61	25,65	11,78	12,80	7,04	8,05
9/16	23,08	23,81	26,34	27,50	13,36	14,42	7,80	8,86
5/8	26,18	26,98	29,84	31,16	14,90	16,02	8,56	9,68
3/4	30,78	31,75	35,10	36,65	18,03	19,25	10,11	11,33
7/8	35,40	36,51	40,36	42,16	21,15	22,48	11,63	12,95
1	40,00	41,27	45,61	47,65	24,28	25,70	13,18	14,61
1 1/8	44,60	46,03	50,85	53,13	27,40	28,93	14,71	16,23
1 1/4	49,22	50,80	56,11	58,65	30,14	31,77	17,45	19,08
1 3/8	53,82	55,56	61,37	64,16	33,27	35,00	18,97	20,70
1 1/2	58,42	60,32	66,60	69,64	36,39	38,22	20,52	22,35
1 5/8	63,01	65,09	71,83	75,15	39,52	41,45	22,05	23,98
1 3/4	67,61	69,85	77,09	80,64	42,64	44,67	23,60	25,63
1 7/8	72,23	74,61	82,34	86,15	45,77	47,90	25,12	27,25
2	76,83	79,37	87,60	91,64	48,89	51,13	26,67	28,91
2 1/4	86,00	88,90	98,09	102,65	54,71	57,17	29,34	31,78
2 1/2	95,25	98,42	108,58	113,63	60,98	63,62	35,59	38,23
2 3/4	104,44	107,95	119,07	124,63	67,23	70,27	38,66	41,50
3	113,66	117,47	129,59	135,63	73,48	76,53	41,73	44,78
3 1/4	122,88	127,00	140,08	146,65	79,34	82,60	44,40	47,65
3 1/2	132,08	136,52	150,57	157,65	85,60	89,05	47,50	50,95
3 3/4	141,27	146,05	161,06	168,65	91,85	95,50	50,55	54,20
4	150,50	155,57	171,57	179,65	98,10	101,95	53,64	57,51
4 1/4	159,71	165,10	182,07	190,65	104,35	108,40	-	-
4 1/2	168,91	174,62	192,56	201,65	110,60	114,85	-	-
4 3/4	178,11	184,15	203,05	212,64	116,84	121,31	-	-
5	187,33	193,67	213,57	223,64	123,09	127,76	-	-
5 1/4	196,53	203,20	224,05	234,64	129,34	134,21	-	-
5 1/2	205,74	212,73	234,54	245,63	135,59	140,67	-	-
5 3/4	214,95	222,25	245,04	256,63	141,83	147,12	-	-
6	224,16	231,78	255,54	267,63	148,08	153,57	-	-

Download PDF Standard

Dimensions of Hex Nuts With Metric Coarse and Fine Pitch Thread

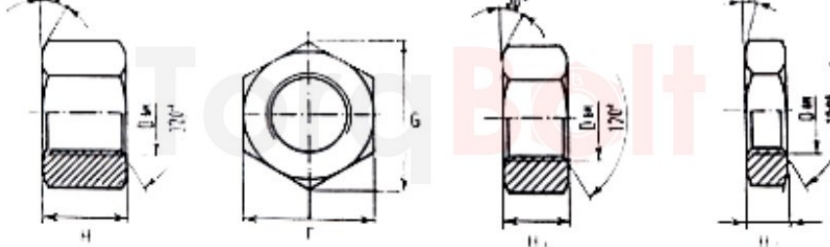

Dimensions of Hex Nuts With Metric Coarse and Fine Pitch Thread

Nominal Size	Width Across Flats		Width Across Corners		DIN 934 H=D		DIN 934		DIN 936	
	F		G		H		H1		H2	
	min	max	min	max	min	max	min	max	min	max
M 6	9,78	10,00	11,05	11,55	5,70	6,00	4,70	5,00	-	-
M 8	12,73	13,00	14,38	15,00	7,64	8,00	6,14	6,50	4,70	5,00
M 10	16,73	17,00	18,90	19,60	9,64	10,00	7,64	8,00	5,70	6,00
M 12	18,67	19,00	21,10	21,90	11,57	12,00	9,64	10,00	6,64	7,00
M 14	21,67	22,00	24,49	25,40	13,57	14,00	10,30	11,00	7,42	8,00
M 16	23,67	24,00	26,75	27,70	15,57	16,00	12,30	13,00	7,42	8,00
M 18	26,67	27,00	30,14	31,10	17,57	18,00	14,30	15,00	8,42	9,00
M 20	29,67	30,00	33,53	34,60	19,48	20,00	14,90	16,00	8,10	9,00
M 22	31,61	32,00	35,72	36,90	21,48	22,00	16,90	18,00	9,10	10,00
M 24	35,58	36,00	39,98	41,50	23,48	24,00	17,70	19,00	9,10	10,00
M 27	40,38	41,00	45,63	47,30	26,48	27,00	20,70	22,00	10,90	12,00
M 30	45,38	46,00	51,28	53,10	29,48	30,00	22,70	24,00	10,90	12,00
M 33	49,38	50,00	55,80	57,70	32,38	33,00	24,70	26,00	12,90	14,00
M 36	54,26	55,00	61,31	63,50	35,38	36,00	27,40	29,00	12,90	14,00
M 39	59,26	60,00	66,96	69,30	38,38	39,00	29,40	31,00	14,90	16,00
M 42	64,26	65,00	72,61	75,00	41,38	42,00	32,40	34,00	14,90	16,00
M 45	69,26	70,00	78,26	80,80	44,38	45,00	34,40	36,00	16,90	18,00
M 48	74,26	75,00	83,91	86,50	47,38	48,00	36,40	38,00	16,90	18,00
M 52	79,26	80,00	89,56	92,40	51,26	52,00	40,40	42,00	18,70	20,00
M 56	84,13	85,00	95,07	98,10	55,26	56,00	43,40	45,00	20,70	22,00
M 60	89,13	90,00	100,72	103,90	59,26	60,00	46,40	48,00	22,70	24,00
M 64	94,13	95,00	106,37	109,70	63,26	64,00	49,10	51,00	24,70	26,00
M 68	99,13	100,00	112,02	115,50	67,26	68,00	52,10	54,00	24,70	26,00
M 72	104,13	105,00	117,67	121,25	71,26	72,00	56,10	58,00	26,70	28,00
M 76	109,13	110,00	123,32	127,00	75,26	76,00	59,10	61,00	28,70	30,00
M 80	114,13	115,00	128,97	132,80	79,26	80,00	62,10	64,00	30,40	32,00
M 85	119,13	120,00	134,62	138,60	84,13	85,00	66,10	68,00	32,40	34,00
M 90	129,00	130,00	145,77	150,10	89,13	90,00	70,10	72,00	34,40	36,00
M 95	134,00	135,00	151,42	155,90	94,13	95,00	74,10	76,00	36,40	38,00
M 100	144,00	145,00	162,72	167,40	99,13	100,00	78,10	80,00	38,40	40,00
M105	147,50	150,00	168,37	173,21	102,80	105,00	81,80	84,00	40,40	42,00
M110	152,50	155,00	172,32	178,98	107,80	110,00	85,80	88,00	42,40	44,00
M115	162,50	165,00	185,32	190,53	112,80	115,00	89,80	92,00	44,40	46,00
M120	167,50	170,00	190,97	196,30	117,80	120,00	93,80	96,00	46,40	48,00
M125	177,50	180,00	200,57	207,85	122,50	125,00	97,80	100,00	48,40	50,00
M130	180,40	185,00	207,75	213,62	127,50	130,00	101,80	104,00	50,10	52,00
M135	185,40	190,00	213,40	219,40	132,50	135,00	105,80	108,00	52,10	54,00
M140	195,40	200,00	220,80	230,95	137,50	140,00	109,80	112,00	54,10	56,00
M145	205,40	210,00	236,00	242,49	142,50	145,00	113,80	116,00	56,10	58,00
M150	205,40	210,00	236,00	242,49	147,50	150,00	117,80	120,00	58,10	60,00

ASTM A453 Grade 660 Heavy Hex Nuts Dimensional Standards

Nuts	DIN	ISO	BS	ASME		PN	UNI	SAE	IS
				Metric	Imperial				
Heavy Hex Flat Jam Nuts	-	-	-	-	B18.2.2	-	-	-	-
Heavy Hex Flat Nuts	-	-	-	-	B18.2.2	-	-	-	-
Heavy Hex Jam Nuts	-	-	-	-	B18.2.2	-	-	-	-
Heavy Hex Nuts	-	-	-	B18.2.4.6M/B18.2.6M	B18.2.2	-	-	-	-
Heavy Hex Slotted Nuts	-	-	-	-	B18.2.2	-	-	-	-
Heavy Hexagon Full Nuts	-	-	-	-	-	-	5587	-	-

Specifications

ASTM A453
ASTM A638
EN 10269
EN 10083-3

Surface Treatments

Xylan 1070 / 1014 / 1400 / 1424
Xylar 2 / 101
SermaGard 1105 / 1280
Dacromet 320 / 500

Certifications

ISO 9001 - 2015 Certified
PED 2014/68/EC
API 6A ; API 20E; API 20F
NACE MR0175/ISO 15156-2

About Us

[Our Company](#)
[Quality Assurance](#)
[Logistics & Supply Chain](#)
[Contact](#)

🌐 Questions? [Contact us.](#)

📄 Showcase of our [Microsites.](#)

SATISFACTION SURVEY

